

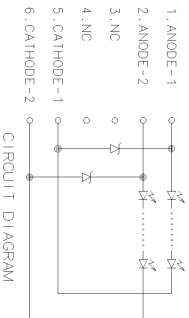

VIEWING DIRECTION: HIGH CONTRAST

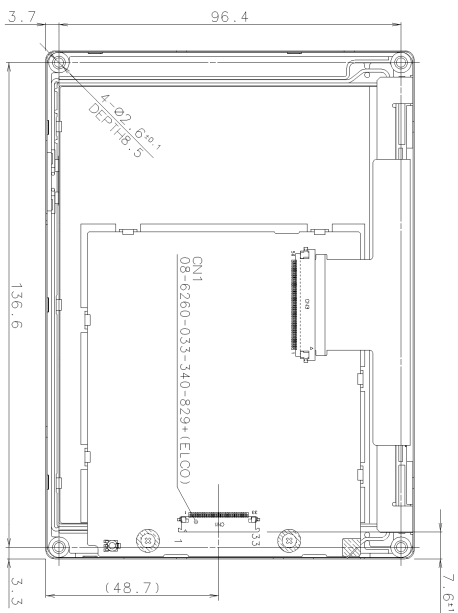
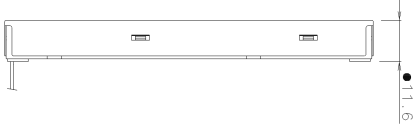
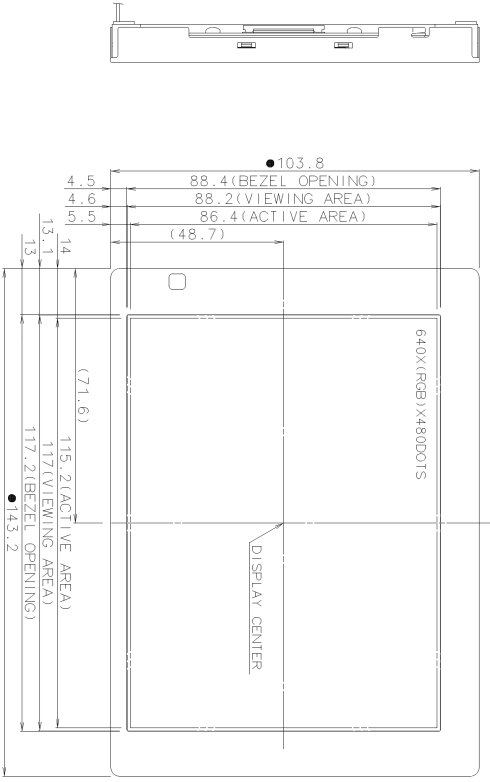

PIN ASSIGNMENT

ON1 No.	SYMBOL	No.	SYMBOL	No.	SYMBOL
1	GND	12	GND	23	B3
2	CK	13	G0	24	B4
3	HSYC	14	G1	25	B5
4	VSYC	15	G2	26	GND
5	GND	16	G3	27	ENAB
6	R0	17	G4	28	WCC(0.3V)
7	R1	18	G5	29	WCC(0.3V)
8	R2	19	GND	30	R/L
9	R3	20	B0	31	U/D
10	R4	21	B1	32	NC
11	R5	22	B2	33	GND

ON2 No.	SYMBOL	CABLE COLOR
1	ANODE-1	RED
2	ANODE-2	RED
3	NC	-
4	NC	-
5	CATHODE-1	BLACK
6	CATHODE-2	BLACK

MEASURE	A	B	C
164-118	±0.1	±0.2	±0.1
63-142-1	±0.2	±0.2	±0.3
280-1500	±0.3	±0.3	±0.4
280C	±0.4	±0.4	±0.4
ANGLE	±1°	±3°	±10°

NOTES
 1. THE DIMENSIONS WITH THE MARK (●) ARE CONTROLLED AS A PARTICULAR CHARACTERISTIC.
 2. TOLERANCE WITHOUT INDICATION: ±0.5

MATERIAL: FINISH:

DATE: 2009/07/21
 DRAWING: PROJECTION: OPTREX CORPORATION
 APPROVED: Madsou Wada
 SCALE: UNIT: DIMENSIONAL OUTLINE
 CHECKED: Yasuo Yamaguchi DATE: 11/11/09 DWG. NO: 0801
 DESIGNED: S. Sano DATE: 11/11/09 DWG. SITE: Az
 DRAWN: S. Sano DWG. REV: